

SPECIFICATIONS

FUNCTION:
1P1T OFF-(ON) + 1P1T ON-(OFF)

RATINGS:
ANSI/UL 1054 and CAN/CSA C22.2 No. 55 (E194579):
18A 125VAC [cURus]
12A 250VAC [cURus]

EN61085-1:
12(10)A 250V~ 5E4 [TÜV]

OPERATING FORCE:
3.0kgf±0.5kgf

ELECTRICAL LIFE:
6,000 Cycles [cURus]
50,000 Cycles [TÜV]

APPROVALS:

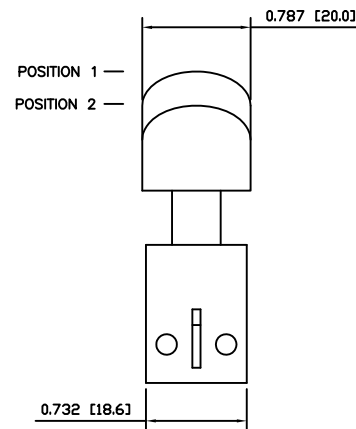
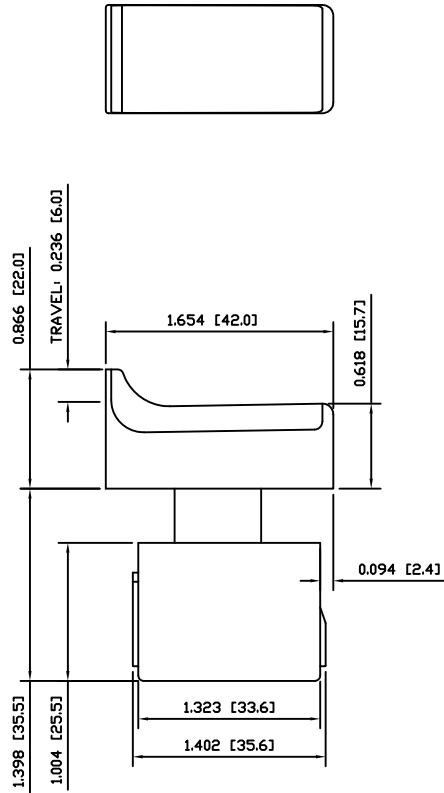

COLORS

BODY:
White
ACTUATOR:
Orange/Black
LOCK:
None

SCHEMATIC

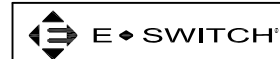
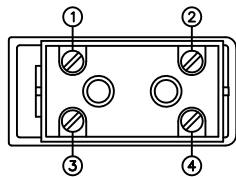
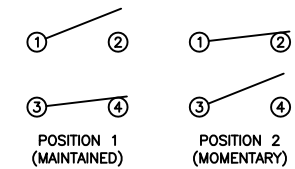

HY15-6Y7-13A-0000

BODY	A	09/07/10	CAB
COLORS	A	09/07/30	CAB
SPECIFICATIONS	A	09/07/10	CAB
REFERENCE	REV.	DATE	BY

THE INFORMATION CONTAINED IN THIS DOCUMENT IS PROPRIETARY TO E-SWITCH AND IS NOT TO BE COPIED OR TRANSFERRED

A	INITIAL RELEASE	PCRD0053	09/07/30	CAB
REV.	DESCRIPTION	PCR	DATE	DRAWN BY

DIMENSIONS	INCHES [MILLIMETERS]
GENERAL TOLERANCES	±0.020 [±0.5] / ±1'
SCALE	DRAWING NOT TO SCALE

PROJECTION	DRAWING NUMBER	DATE	REVISION
	34-HY156Y713A0000	JULY 30, 2009	A